

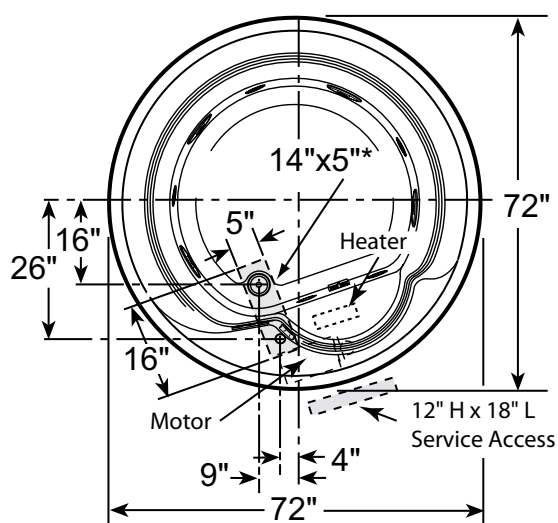

Cortina® WHIRLPOOL BATH

EE35 Cortina® Whirlpool Bath, Right Hand

- Center Drain Location
- Accessories / Hardware:
 - Trim Kit: AccuPro™ Jet Rings #P556 (2 required)
 - Trim Kit: PowerPro™ Jet Rings #M952
 - Trip-Lever Drain Kit #X559
 - Rotary Drain Kit, 26" Cable #8730
- Trim Kit Finishes Available:
 - (827) – Chrome
 - (898) – Brushed Chrome
 - (815) – Satin Nickel
 - (829) – Bright Brass
 - (805) – Platinum
 - (826) – Brushed Nickel
 - (849) – Oil Rubbed Bronze



Product Shown: Cortina® Whirlpool Bath
Right Hand Shown Model: EE35

** Measurements inside unit represent cutout in floor to allow for drain/overflow.*

INSTALLATION NOTES

Refer to installation instructions included with fixture before beginning installation. Please confirm product availability and specifications before commencing with any installation work.

PRODUCT SPECIFICATIONS AND AVAILABILITY ARE SUBJECT TO CHANGE WITHOUT NOTICE.

Technical Specifications

DIMENSIONS

72" L x 72" W x 22 1/4" H
(1829 mm) L x (1829 mm) W x (565 mm) H

DRAIN/OVERFLOW

A: 16 3/4" (426 mm) B: 19 1/4" (489 mm)

CUTOUT

70" Dia. Hole

TOTAL WEIGHT

1343 lb (609 kg) / 46 lb/sq. ft. (225 kg/m²)

OPERATING GALLONAGE

100 U.S. Gal. (379 Liters)

PRODUCT WEIGHT

210 lb (95 kg)

SKIRT MOUNTING

Not Available

ELECTRICAL SPECIFICATIONS

Requires a dedicated GFCI protected separate circuit.

Motor/Pump: 120 VAC, 20 AMP, 60 Hz.

RapidHeat™: 115 VAC, 15 AMP, 60 Hz.

HEATER (STANDARD)

Requires a dedicated GFCI protected separate circuit.

RapidHeat™: P/N U395000

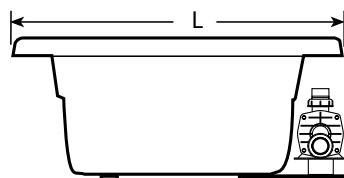

SIDE VIEW

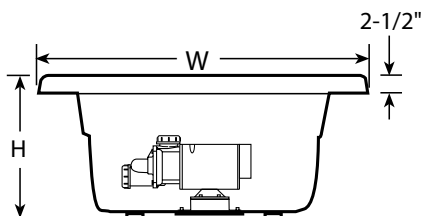

END VIEW

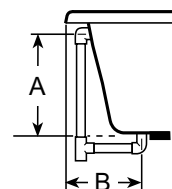

DRAIN/OVERFLOW